

Creating chemical reactions,
handling the slimy slime and
feeling the magic sand.....

MAGIC!

Play and Learn with
14 Easy Sensory
Experiments!

VOLCANOL

HOW TO DO IT

1. Place the test tube onto the tube stand and pour some water.
2. Add some baking soda and stir until well mixed.
3. Drop 1-2 drops red pigment.
4. Pour some oil.
5. Add some citric acid.
6. Watch the volcano ERUPT underwater!

**WATCH
IT POP!**



MAGIC CLAY

HOW TO DO IT

1. Just touch the clay and feel its weight. What's the difference with the common clay?
2. Freely stretch, fold and shape it.

3. You can also add red pigment and blue pigment to turn it to other color!



AMAZING REACTION

HOW TO DO IT

1. Prepare 2 cups to respectively dissolve the citric acid and baking soda.
2. Respectively add purple cabbage powder into the citric acid solution and baking soda solution.
3. What's going on? The citric acid solution turns red while the baking soda solution turns blue.
4. Mix the red solution and the blue solution, What happen? FIZZY!



**LOOK!
IT'S
FIZZING!**



COLORFUL RAIN

HOW TO DO IT

1. Pour some oil into the cup.
2. Drop the red pigment and blue pigment,
3. Stir to make pigment particles smaller.
4. Place the test tube onto the tube stand.
Add some water into the test tube.
5. Gently pour some oil of step 3 into the tube.
6. Watch the colorful rain occur!

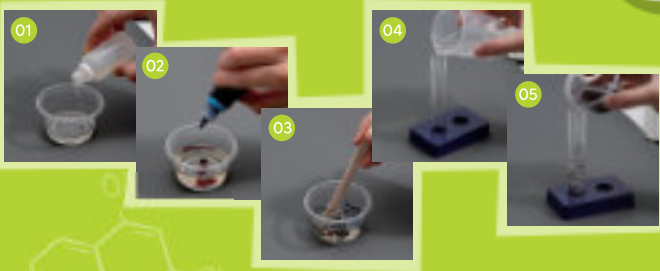

Colors Falling!

COLOR RELAY

HOW TO DO IT

1. Prepare equal red and blue solution with 2 cups.
2. Mix the 2 colored solution. What happen?
3. Prepare 3 cups and 2 pieces tissues. Respectively pour the red solution and blue solution into the cups. Insert the empty cup in the middle.



4. Fold the tissues into long strips. Connect the 3 cups with the 2 tissue strips.
5. What's going on after standing for a while? The tissue in the empty containers will have water. And they are all of different colors!



SPACE SAND

HOW TO DO IT

1. Knead it freely! It can NEVER get stick on your hand!
2. You can also use your own tools to build sand castle!

Squeeze
+
Sculpt!

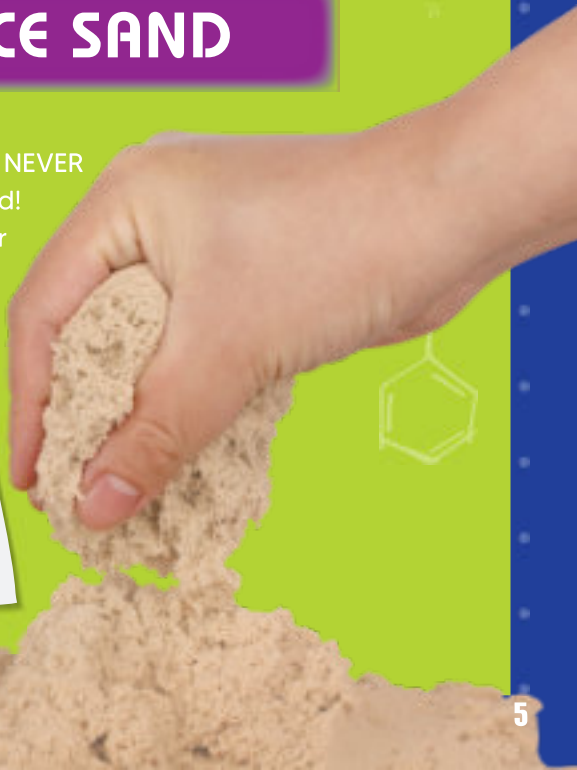

FROZEN

HOW TO DO IT

1. Add snow powder into the cup and pour some water.
2. The powder magically expand into snow form!
3. Just use the snow to pinch a snowman!
4. Repeat step1-2 to make colored snow with the pigment.



WATCH IT TRANSFORMS TO ICE!

Color Eruption!

HOW TO DO IT

1. Place the test tube onto the tube stand and add some water into the tube.
2. Add some baking soda and stir until well mixed. Then add some color according your preference.
3. Take a cup and add citric acid and water, stir until well mixed.
4. Pour the citric acid into the tube. Watch the color erupt! Just like a fun art!

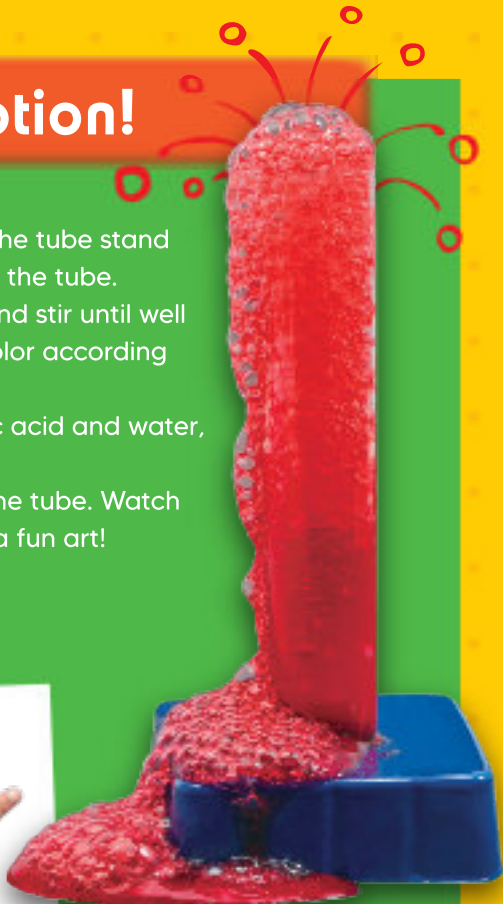

**WHOA!
COLOR
EXPLODE!**

MAGIC SAND

HOW TO DO IT

1. Add some water into the cup and pour some magic sand into it.
2. What magic occur? The sand is insoluble in water!
3. Spoon out the sand, it is still dry!
4. Take some sand with your finger and soak it into the water. You'll find the sand is also dry!
5. Let's try to make a pit with the sand. Drop some water onto the center hole of the sand. The sand magically hold the water!

Dip + Feel!

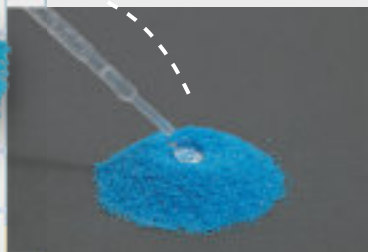

SQUISHY SLIME



HOW TO DO IT

1. Pour the glue into the cup.
2. Add some dietary alkali powder.
*The ratio of the glue and dietary alkali powder is 10:1.
3. Gently stir it until well mixed to form a slime.

Icky + Gooey!



FUN FOAM



HOW TO DO IT

1. Pick up the foam beads.
2. Feel its weight and touch.
3. Gently pinch and rub the beads.
4. Gradually they stick to your hand!

Feel the foam!

SLIMY SLIME

HOW TO DO IT

1. Add a bag slime powder and 56 ml water into the measuring cup.
 - * Always add the powder FIRST!
 - * If you don't use all of a bag slime powder, always keep the ratio of the slime powder and water in 1:8.
2. Gently stir it until well mixed to form a slime. (*This would take around 10-20 minutes.)
3. Just play the Slime with your hands. Goopy but FUN!

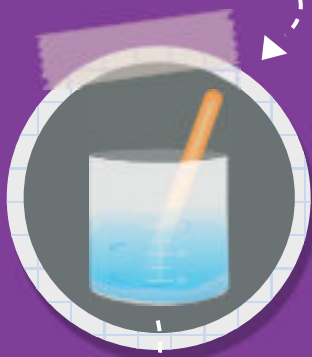

GLOWING Slime

HOW TO DO IT

1. Sprinkle some glow powder onto the basic slime done before.
2. Mix it up! Let the glow powder mix well with the slime.
3. Put it under the light for a while.
4. Place it in a dark room. What'll you see?
Your slime is GLOWING!



Glow in the dark!



DISGUSTING VOMIT

HOW TO DO IT

1. Prepare an experiment tray and pour some corn starch. (*Experiment tray required from home.)
2. Make a hole in the middle of the corn starch and add some water.
3. You can divide the corn starch into 2 parts. Drop blue pigment to one and drop red pigment to the other one.
4. Use your hand to stab it. You'll find mixture get harden.
5. You can also try to pick some up. Knead and feel. Sticky!



STICKY!

